

POV Hat 2

POV Hat 1

Toggle 1-6 (Standard)

Toggle 1-6 (Switched)

Simulator/Program:
Aircraft:

Fire

--	--

Fire C

--	--

Trigger

--	--

Second Trigger

--	--

X52 HOTAS - Document Created By Damien St Pierre
Profile Creator:

Mode Switch

M1	
M2	
M3	

Fire A

--	--

Fire B

--	--

Pinkie Trigger

--

Recommended modifier button

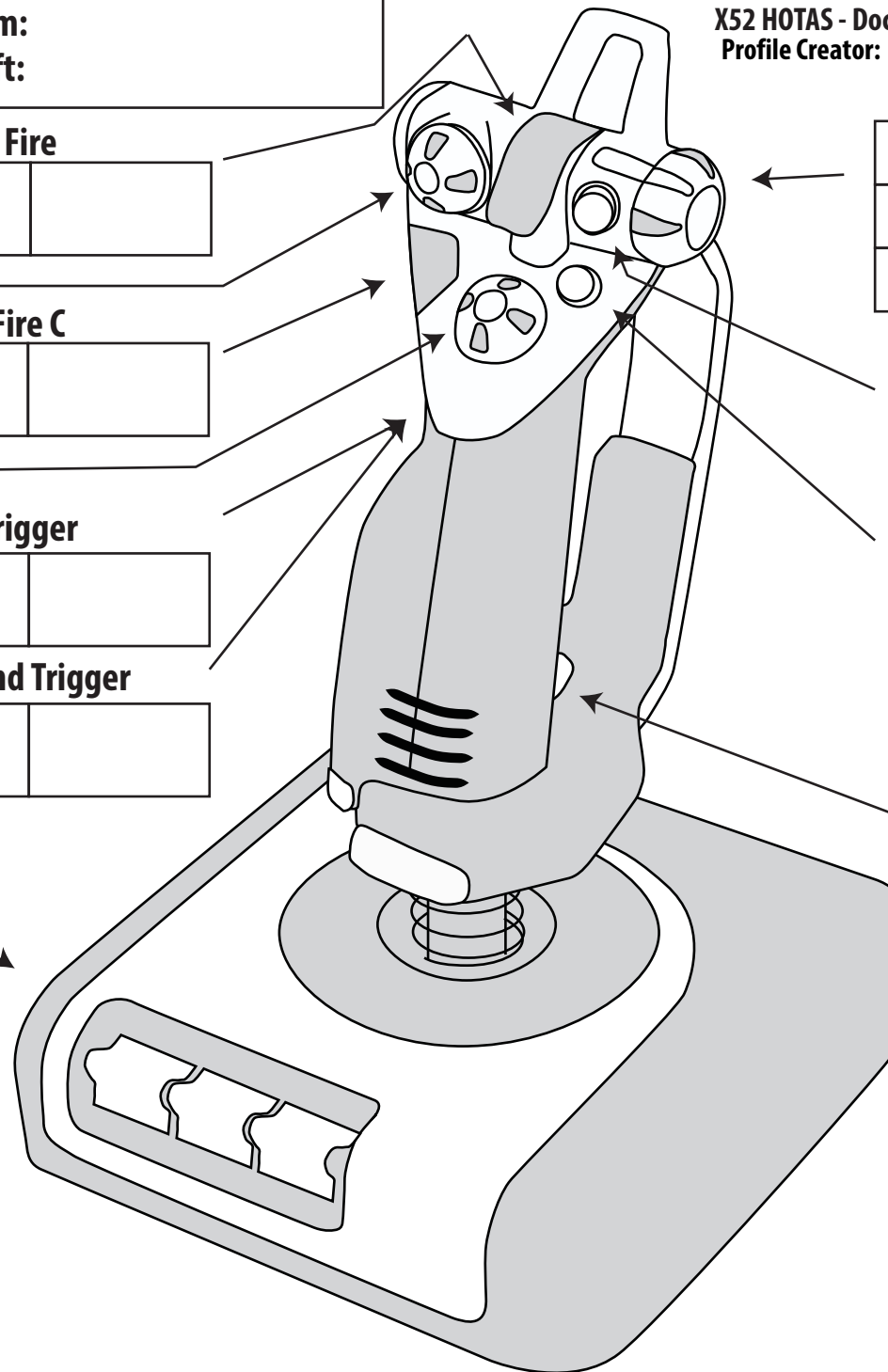

NOTE:
A Button must be set to switch state/modifier for shifted functions to work.
The Pinkie Switch is recommended for effective HOTAS operations. If the simulator doesn't have options to add modifiers set the PT to Ctrl or Shift in the Profile Editor.

Legend

Normal Function Shifted Function

BUTTON	MODIFIER + BUTTON
--------	-------------------

Simulator/Program:

Aircraft:

X52 HOTAS - Document Created By Damien St Pierre

Profile Creator:

POV Hat 3

Wheel Mouse Botton 2

Click	
Up	
Down	

Mlni Stick

Throttle Base Buttons (Standard)

(Switched)

Mouse Button

--	--

Clutch Fixed

--	--

"Clutch" function must be Disabled in

Saitek Control Panel

Fire E

--	--

Rotary 2

Fire D

--	--

Slider

Rotary 1

NOTE:

Slider and Rotary Wheels must be

set to Bands in Saitek Profile Editor to

simulate swithces or buttons.

The Ministick may have to be set as well

Recommended Bands are

0-20%, 20-80%, 80-100%